

ACCOMMODATIONS

- 247 spacious two-room suites
- Private bedroom with one king size or two double beds
- Separate living room with sofa bed and well-lit dining/work table
- Wet bar, microwave, coffeemaker and refrigerator
- Two dual-line telephones with computer port
- Two televisions with cable and in-room movies

AMENITIES

- Complimentary cooked-to-order breakfast
- Nightly Manager's Reception†

RECREATIONAL SERVICES

- Convenient, relaxing outdoor pool
- Fun-filled game room
- Reinvigorating whirlpool and sauna
- On-site, cardiovascular fitness center

DINING AND ENTERTAINMENT

- Specialty steaks and grilled entrees for lunch and dinner at Mangroves Grille
- Soothing piano sounds in the Oak Tree Lounge, located in our skylit atrium

TRANSPORTATION

- Complimentary shuttle within 5-mile radius

LOCATION

- Easy access to highways I-75 and I-275
- Only 1/2 mile north of Busch Gardens
- On the University of South Florida campus



The Hilton Family Hilton HHonors®
Points & Miles

†Subject to state and local laws. *Hilton HHonors membership, earning of Points & Miles,™ and redemption of points are subject to HHonors Terms and Conditions. © 2005 Hilton Hospitality, Inc.



**EMBASSY SUITES
HOTEL®**

USF/Near Busch Gardens



**3705 Spectrum Boulevard
Tampa, FL 33612
Telephone: 813-977-7066 • Fax: 813-977-7933
www.embassysuitesusf.com**

For reservations call the hotel directly or nationwide call 1-800-EMBASSY or visit our Web site at www.embassysuites.com In Mexico, call: 001-800-362-2779 For meeting information, call toll free 800-321-3232

**Chain Code ES:
SABRE 41356/APOLLO 87388
WORLDSPAN 4604
SYS One/Amadeus-TPAGW1**

**Directions:
From I-75 North or South, take Exit 265 (Fowler Ave.) West 4.3 miles to Spectrum Blvd. Also, from I-275, take Exit 51 (Fowler Ave.) East 2.3 miles.**

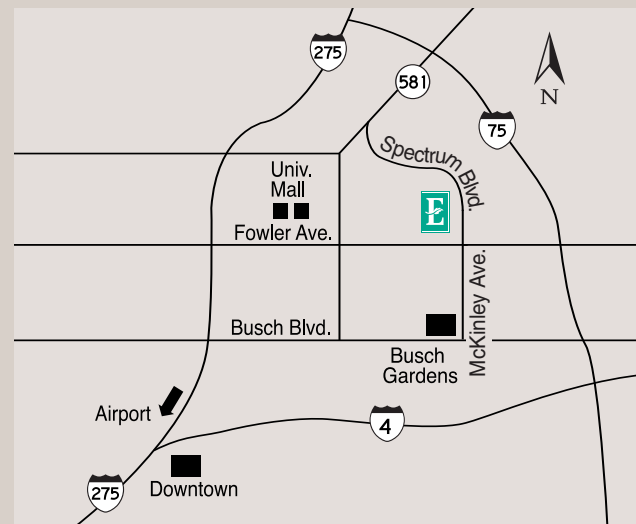

MEETING SPACE FLOOR PLANS

University Board Room
24' x 14'

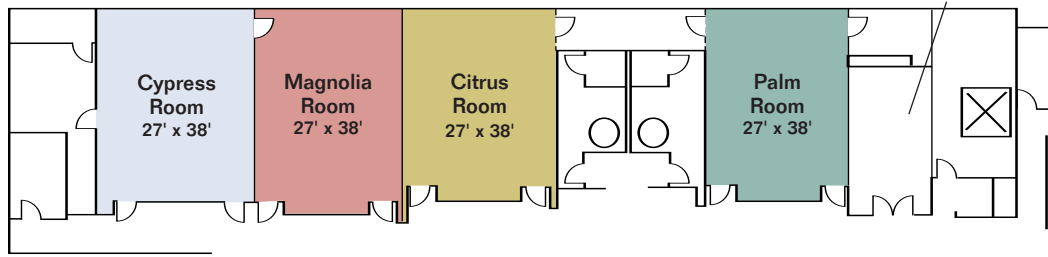

110 Volt
220 Volt
T1 T-1 Line

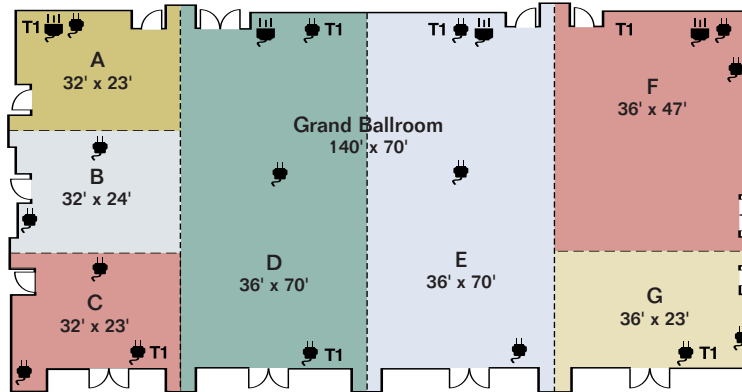

MEETING SPACE CAPACITIES

| | Round 10 | Crescent RDS | Reception | Theater | Classroom | U-Shape | Hollow Square | Booths |
|-----------------------------|----------|--------------|-----------|---------|-----------|---------|---------------|--------|
| Cypress Room | 50 | 25 | 75 | 75 | 50 | 30 | 35 | 6 |
| Magnolia Room | 50 | 25 | 75 | 75 | 50 | 30 | 35 | 6 |
| Citrus Room | 50 | 25 | 75 | 75 | 50 | 30 | 35 | 6 |
| Palm Room | 50 | 25 | 75 | 75 | 50 | 30 | 35 | 6 |
| Grand Ballroom | 600 | 300 | 1400 | 1200 | 600 | 0 | 0 | 50 |
| Salon A | 40 | 20 | 60 | 75 | 45 | 20 | 20 | 4 |
| Salon B | 40 | 20 | 60 | 75 | 45 | 20 | 20 | 4 |
| Salon C | 40 | 20 | 60 | 75 | 45 | 20 | 20 | 4 |
| Salon A, B, C | 150 | 60 | 200 | 300 | 150 | 55 | 60 | 12 |
| Salon D | 150 | 60 | 200 | 300 | 150 | 55 | 60 | 12 |
| Salon E | 150 | 60 | 200 | 300 | 150 | 55 | 60 | 12 |
| Salon F | 100 | 50 | 120 | 100 | 80 | 50 | 50 | 8 |
| Salon G | 40 | 20 | 60 | 75 | 45 | 20 | 20 | 4 |
| Atrium Comp Area | 0 | 0 | 160 | 0 | 0 | 0 | 0 | 10 |
| Atrium Comp Area World Car. | 300 | 0 | 350 | 0 | 0 | 0 | 0 | 55 |
| Atrium Entire | 300 | 0 | 350 | 0 | 0 | 0 | 0 | 20 |
| Convention Office | 20 | 10 | 0 | 30 | 20 | 12 | 20 | 2 |
| Pool Deck | 0 | 0 | 70 | 0 | 0 | 0 | 0 | 0 |
| Presidential Suite | 0 | 0 | 35 | 0 | 0 | 0 | 0 | 0 |
| Waterfall Atrium | 80 | 35 | 150 | 140 | 0 | 25 | 25 | 10 |
| Pre-Function | 60 | 0 | 70 | 0 | 0 | 0 | 0 | 8 |

MEETING SPACE INFORMATION

- 18,000 square feet of meeting space
- 9,800-square-foot Grand Ballroom
- 22 individual meeting rooms
- In-house audiovisual services available
- Seven King Executive Meeting Suites
- University Boardroom accommodates 12 people conference style
- Grand Ballroom ceiling height is 18'
- 2nd floor meeting room's ceiling height is 10'

