

MEETING SPACE FLOOR PLANS

University Board Room
24' x 14'

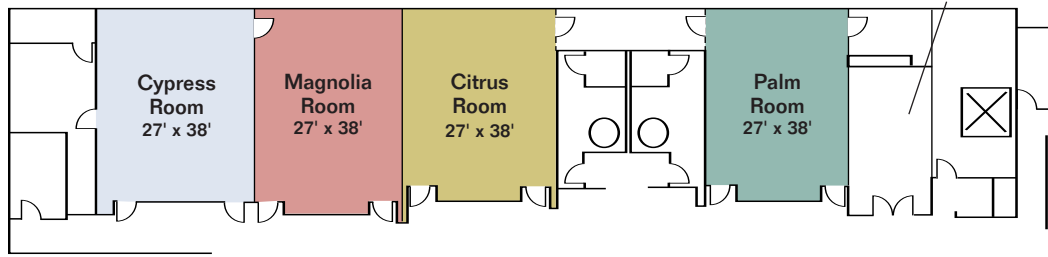

110 Volt
220 Volt
T1 T-1 Line

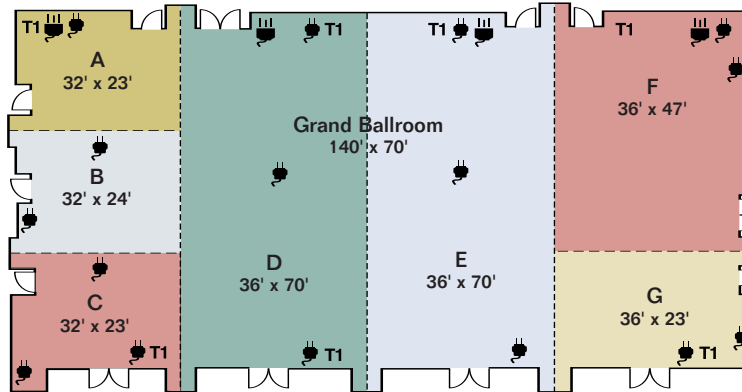

MEETING SPACE CAPACITIES

	Round 10	Crescent RDS	Reception	Theater	Classroom	U-Shape	Hollow Square	Booths
Cypress Room	50	25	75	75	50	30	35	6
Magnolia Room	50	25	75	75	50	30	35	6
Citrus Room	50	25	75	75	50	30	35	6
Palm Room	50	25	75	75	50	30	35	6
Grand Ballroom	600	300	1400	1200	600	0	0	50
Salon A	40	20	60	75	45	20	20	4
Salon B	40	20	60	75	45	20	20	4
Salon C	40	20	60	75	45	20	20	4
Salon A, B, C	150	60	200	300	150	55	60	12
Salon D	150	60	200	300	150	55	60	12
Salon E	150	60	200	300	150	55	60	12
Salon F	100	50	120	100	80	50	50	8
Salon G	40	20	60	75	45	20	20	4
Atrium Comp Area	0	0	160	0	0	0	0	10
Atrium Comp Area World Car.	300	0	350	0	0	0	0	55
Atrium Entire	300	0	350	0	0	0	0	20
Convention Office	20	10	0	30	20	12	20	2
Pool Deck	0	0	70	0	0	0	0	0
Presidential Suite	0	0	35	0	0	0	0	0
Waterfall Atrium	80	35	150	140	0	25	25	10
Pre-Function	60	0	70	0	0	0	0	8

MEETING SPACE INFORMATION

- 18,000 square feet of meeting space
- 9,800-square-foot Grand Ballroom
- 22 individual meeting rooms
- In-house audiovisual services available
- Seven King Executive Meeting Suites
- University Boardroom accommodates 12 people conference style
- Grand Ballroom ceiling height is 18'
- 2nd floor meeting room's ceiling height is 10'

